

UCO-UCC-UCP-UCL

Fissacavi doppi per cavi coassiali

Versioni:

- ① **UCO** per piatto forato
- ② **UCC** per piatto, tondo e angolare
- ③ **UCP** per profilato **PCI 40/22**
- ④ **UCL** per passerelle portacavi in filo d'acciaio

Composizione:

- 1 - Selle doppie **SAB** di H.D.P.E. rinforzato vetro
- 2 - Barra filettata - **BFI M8** (M10 a richiesta)
- 3 - Piastre di spinta **PUC**
- 4 - Dadi esagonali **DAI 8**
- 5 - Rondelle elastiche **REI 8**

Impiego:

Fissaggio 1 - 8 cavi coassiali.
Fissaggio di guide d'onda mediante guarnizioni elastiche **GRE-GRQ-GRR**.

Materiale:

Acciaio INOX AISI 304 (V 2A).
H.D.P.E. rinforzato con fibra di vetro, resistente a U.V.
Colore: nero (grigio a richiesta).



UCO-UCC-UCP-UCL

Doppel-Schellen für Koaxialkabel

Versionen:

- ① **UCO** für gelochtes Flacheisen
- ② **UCC** für Flach-, Rund-, Winkelisen
- ③ **UCP** für Profil **PCI 40/22**
- ④ **UCL** für Gitterbahnen

Zusammenbau:

- 1 - **SAB** Doppelwannen aus glasf. verst. H.D.P.E.
- 2 - Gewindestange - **BFI M8** (M10 auf Anfrage)
- 3 - Druckplatten **PUC**
- 4 - **DAI 8** Muttern
- 5 - **REI 8** Sicherungsscheiben

Einsatz:

Befestigung von 1 - 8 Koaxialkabeln.
Mittels elastischen Klemmprofilen **GRE-GRQ-GRR** auch Wellenleiter.

Material:

Stahl AISI 304 (V2A).
H.D.P.E. glasfaserverstärkt, U.V. - beständig.
Farbe: schwarz (grau auf Anfrage).

UCO-UCC-UCP-UCL

Twin Coaxial Cable Clamps

Versions:

- ① **UCO** for flat iron with holes
- ② **UCC** for flat, round, angular
- ③ **UCP** for profile **PCI 40/22**
- ④ **UCL** for steel wire cable trays

Components:

- 1 - **SAB** double saddles made from reinforced H.D.P.E.
- 2 - Threaded bar - **BFI M8** (M10 on request)
- 3 - **PUC** steel-Flanges
- 4 - **DAI 8** Hexagonal Nuts
- 5 - **REI 8** Elastic Washers

Use:

Fixing 1 to 8 coaxial cables.
GRE-GRQ-GRR elastic cushions allow fastening of waveguides.

Material:

Stainless steel AISI 304 (V 2A).
Fiberglass H.D.P.E., U.V. proof.
Colour: black (grey on request).

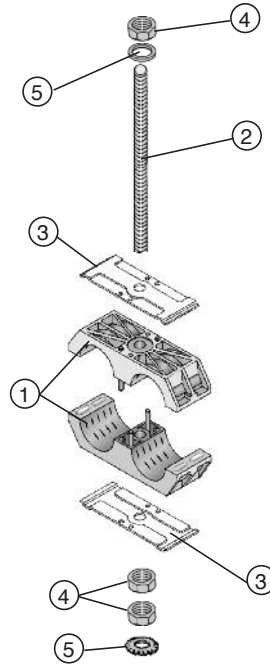

UCO-UCC-UCP-UCL

Fixations doubles pour câbles coaxiaux

Versions:

- ① **UCO** pour fer plat avec trous
- ② **UCC** pour plat, rond et cornière
- ③ **UCP** pour profilé **PCI 40/22**
- ④ **UCL** pour structures en fil acier

Composition:

- 1 - Garnitures **SAB** en H.D.P.E. renforcé fibre de verre
- 2 - Tiges filetées - **BFI M8** (M10 sur demande)
- 3 - Plaques **PUC**
- 4 - Ecrous hexagonaux **DAI 8**
- 5 - Rondelles dentelées **REI 8**

Emploi:

Fixation de 1 à 8 câbles coaxiaux.
Fixation de guides d'onde avec garnitures **GRE-GRQ-GRR**.

Matériel:

Inox AISI 304 (V2A).
H.D.P.E. fibre de verre, résistant aux U.V.
Couleur: noir (gris sur demande).

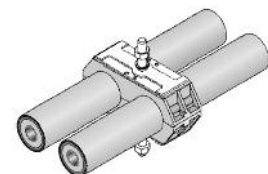
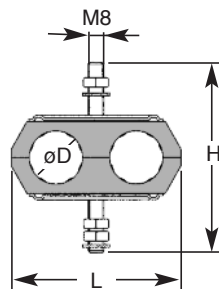
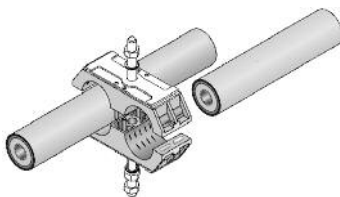

SAB - Selle calibrate gemellate

Grazie alla dentellatura speciale interna fanno presa sul cavo coassiale senza comprimerlo né deformarlo. La chiusura di due selle abbinata è calibrata sui diametri dei cavi coassiali.

Material:

H.D.P.E. rinforzato con fibra di vetro.
Resistente ai raggi U.V. (-50°C ÷ +80°C)
Colore: nero (grigio a richiesta).

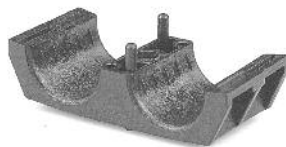

SAB - Calibrated Twin Saddles

The internal indentation allows gripping on the cable without compressing nor deforming it. The fitting of the two saddles is calibrated and corresponds to the diameter of the coaxial cables.

Material:

Fiberglass reinforced H.D.P.E.
U.V. proof. (-50°C ÷ +80°C)
Colour: black (grey on request).

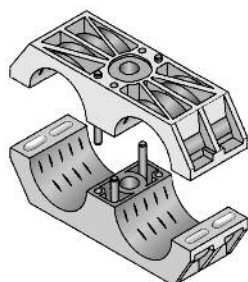

SAB - Zweispurige Kalibrierte Klemmwannen

Sie entsprechen dem Standarddurchmesser der sRF-Koaxialkabel die formschlüssig eingebettet werden. Innenangebrachte Noppen haften am Kabelmantel ohne ihn zusammenzudrücken oder zu beschädigen.

Material:

H.D.P.E. glasfaserverstärkt.
U.V. beständig (-50°C ÷ +80°C)
Farbe: schwarz (grau auf Anfrage).

SAB - Garnitures calibrées jumellées

Elles sont calibrées pour le diamètre des câbles coaxiaux. Grâce aux dentelures intérieures elles fixent le câble sans le comprimer ni le déformer.

Matériel:

H.D.P.E. renforcé fibre de verre.
Résistant aux rayons U.V. (-50°C ÷ +80°C)
Couleur: noir (gris sur demande).



Figura Figure Abbildung Figure	Code Code Artikel Nr. Code	Articolo Article Artikel Article	ø D	h	L			g 	Prezzo Price Preis Prix
	61 3307 5009	SAB/ 2x9	8 - 9	10,5	56	20	500	14	
	61 3307 5011	SAB/ 2x11	10 - 11	10,5	56	20	500	14	
	61 3307 5013	SAB/ 2x13	12 - 13	13,5	68	20	500	18	
	61 3307 5014	SAB/ 2x1/2" S (14)	13 - 14	13,5	68	20	500	18	
	61 3307 5038	SAB/ 2x3/8" (16)	15 - 16	13,5	68	20	500	18	
	61 3307 5012	SAB/ 2x1/2" (17)	16 - 17	13,5	68	20	500	18	
	61 3307 5058	SAB/ 2x5/8" (23)	21 - 23	19	90	20	100	25	
	61 3307 5078	SAB/ 2x7/8" (28)	27 - 28	19	90	20	100	25	
	61 3307 5178	SAB/ 2x7/8" M (30)	29 - 30	19	90	20	100	25	
	61 3307 5118	SAB/ 2x1.1/8" (38)	36 - 38	27	114	20	100	30	
	61 3307 5114	SAB/ 2x1.1/4" (40)	39 - 40	27	114	20	100	30	
	61 3307 5148	SAB/ 2x1.5/8" S (49)	48 - 49	33	137	20	100	40	
	61 3307 5158	SAB/ 2x1.5/8" (52)	50 - 52	33	137	20	100	40	



UCO - Fissacavi doppi per piatto forato

Composizione:
Sella **SAB** + perno filettato M8 + dadi + rondelle

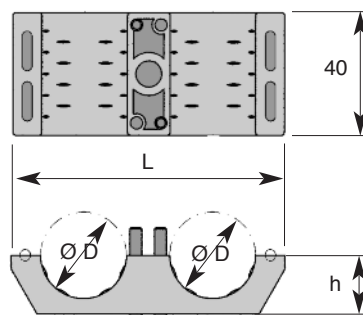
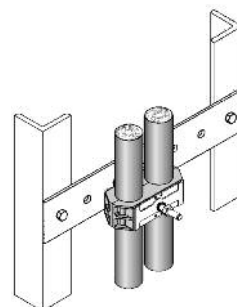
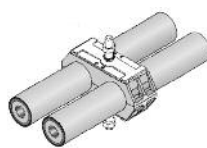
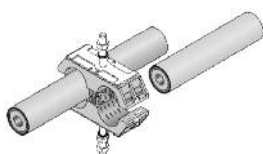

UCO - Doppel Kabelschellen für gelochtes Flacheisen

Zusammenbau:
SAB Wannen + Gewindest. M8 + Muttern + Scheiben

UCO - Twin Cable Clamps for flat iron with holes

Composition:
SAB Saddle + M8 threaded bar + nuts + washers

UCO - Fixations doubles pour fer plat avec trous

Composition:
Garniture **SAB** + tige fil. M8 + écrous + rondelles

Figura Figure Abbildung Figure	Codice Code Artikel Nr. Code	Articolo Article Artikel Article	ø D	H	h1	L				g	Prezzo Price Preis Prix
<p>2 Cavi 2 Kabel</p> <p>UCO/2</p>	61 1559 0209	UCO/ 2x9	8 - 9	75	21	56	20			95	
	61 1559 0211	UCO/ 2x11	10 - 11	75	21	56	20			95	
	61 1559 0213	UCO/ 2x13	12 - 13	75	27	68	20			100	
	61 1559 0214	UCO/ 2x1/2" S (14)	13 - 14	75	27	68	20			100	
	61 1559 0238	UCO/ 2x3/8" (16)	15 - 16	75	27	68	20			100	
	61 1559 0212	UCO/ 2x1/2" (17)	16 - 17	75	27	68	20			100	
	61 1559 0258	UCO/ 2x5/8" (23)	21 - 23	100	38	90	20			155	
	61 1559 0278	UCO/ 2x7/8" (28)	27 - 28	100	38	90	20			155	
	61 1559 2118	UCO/ 2x1.1/8" (38)	36 - 38	150	54	114	20			200	
	61 1559 2114	UCO/ 2x1.1/4" (40)	39 - 40	150	54	114	20			200	
<p>2 Cables 2 Câbles</p>	61 1559 2158	UCO/ 2x1.5/8" (52)	50 - 52	150	66	137	20			280	
<p>4 Cavi 4 Kabel</p> <p>UCO/4</p>	61 1559 0409	UCO/ 4x9	8 - 9	100	42	56	20			120	
	61 1559 0411	UCO/ 4x11	10 - 11	100	42	56	20			120	
	61 1559 0413	UCO/ 4x13	12 - 13	125	54	56	20			150	
	61 1559 0414	UCO/ 4x1/2" S (14)	13 - 14	125	54	68	20			150	
	61 1559 0438	UCO/ 4x3/8" (16)	15 - 16	125	54	68	20			150	
	61 1559 0412	UCO/ 4x1/2" (17)	16 - 17	125	54	68	20			150	
	61 1559 0458	UCO/ 4x5/8" (23)	21 - 23	150	76	90	20			230	
	61 1559 0478	UCO/ 4x7/8" (28)	27 - 28	150	76	90	20			230	
	61 1559 4118	UCO/ 4x1.1/8" (38)	36 - 38	200	108	114	20			290	
	61 1559 4114	UCO/ 4x1.1/4" (40)	39 - 40	200	108	114	20			290	
<p>4 Cables 4 Câbles</p>	61 1559 4158	UCO/ 4x1.5/8" (52)	50 - 52	250	132	137	20			395	
<p>6 Cavi 6 Kabel</p> <p>UCO/6</p>	61 1559 0609	UCO/ 6x9	8 - 9	125	63	56	20			155	
	61 1559 0611	UCO/ 6x11	10 - 11	125	63	56	20			155	
	61 1559 0613	UCO/ 6x13	12 - 13	150	81	68	20			200	
	61 1559 0614	UCO/ 6x1/2" S (14)	13 - 14	150	81	68	20			200	
	61 1559 0638	UCO/ 6x3/8" (16)	15 - 16	150	81	68	20			200	
	61 1559 0612	UCO/ 6x1/2" (17)	16 - 17	150	81	68	20			200	
	61 1559 0658	UCO/ 6x5/8" (23)	21 - 23	200	114	90	20			305	
	61 1559 0678	UCO/ 6x7/8" (28)	27 - 28	200	114	90	20			305	
	61 1559 6114	UCO/ 6x1.1/4" (40)	39 - 40	250	150	114	20			380	
	61 1559 6158	UCO/ 6x1.5/8" (52)	50 - 52	300	198	137	20			520	
<p>6 Cables 6 Câbles</p>											
<p>8 Cavi 8 Kabel</p> <p>UCO/8</p>	61 1559 0809	UCO/ 8x9	8 - 9	150	84	56	20			190	
	61 1559 0811	UCO/ 8x11	10 - 11	150	84	56	20			190	
	61 1559 0813	UCO/ 8x13	12 - 13	200	108	68	20			145	
	61 1559 0814	UCO/ 8x1/2" S (14)	13 - 14	200	108	68	20			145	
	61 1559 0838	UCO/ 8x3/8" (16)	15 - 16	200	108	68	20			145	
	61 1559 0812	UCO/ 8x1/2" (17)	16 - 17	200	108	68	20			145	
	61 1559 0858	UCO/ 8x5/8" (23)	21 - 23	250	152	90	20			370	
	61 1559 0878	UCO/ 8x7/8" (28)	27 - 28	250	152	90	20			370	
	<p>8 Cables 8 Câbles</p>										

Esempio di fissaggio piatti forati
Fixings example on flat iron with holes



Befestigung-Beispiel an gelochtes Flacheisen
Exemple de fixations sur fer plat avec trous



UCC - Fissacavi doppi per piatti, tondi e angolari

Composizione:
UCO + morsetto monoblocco MCM 8

UCC - Cable Clamps for flat, round and angular

Composition:
UCO + MCM 8 Compact Clamp

UCC - Doppel Kabelschellen für Flach, Rund, Winkeleisen

Zusammenbau:
UCO + Kompakt-Klemme MCM 8

UCC - Fixations doubles pour plat, rond et cornière

Composition:
UCO + attache compacte MCM 8



Figura Figure Abbildung Figure	Codice Code Artikel Nr. Code	Articolo Article Artikel Article	ø D	H	h1	L			g 	Prezzo Price Preis Prix
2 Cavi UCC/2	61 1560 0209	UCC/ 2x9	8 - 9	75	21	56	20	205		
	61 1560 0211	UCC/ 2x11	10 - 11	75	21	56	20	205		
	61 1560 0213	UCC/ 2x13	12 - 13	75	27	68	20	210		
	61 1560 0214	UCC/ 2x1/2" S (14)	13 - 14	75	27	68	20	210		
	61 1560 0238	UCC/ 2x3/8" (16)	15 - 16	75	27	68	20	210		
	61 1560 0212	UCC/ 2x1/2" (17)	16 - 17	75	27	68	20	210		
	61 1560 0258	UCC/ 2x5/8" (23)	21 - 23	100	38	90	20	265		
	61 1560 0278	UCC/ 2x7/8" (28)	27 - 28	100	38	90	20	265		
	61 1560 2118	UCC/ 2x1.1/8" (38)	36 - 38	150	54	114	20	265		
	61 1560 2114	UCC/ 2x1.1/4" (40)	39 - 40	150	54	114	20	310		
2 Cables 2 Câbles	61 1560 2158	UCC/ 2x1.5/8" (52)	50 - 52	150	66	137	20	310		
4 Cavi UCC/4	61 1560 0409	UCC/ 4x9	8 - 9	100	42	56	20	390		
	61 1560 0411	UCC/ 4x11	10 - 11	100	42	56	20	230		
	61 1560 0413	UCC/ 4x13	12 - 13	125	54	56	20	230		
	61 1560 0414	UCC/ 4x1/2" S (14)	13 - 14	125	54	68	20	260		
	61 1560 0438	UCC/ 4x3/8" (16)	15 - 16	125	54	68	20	260		
	61 1560 0412	UCC/ 4x1/2" (17)	16 - 17	125	54	68	20	260		
	61 1560 0458	UCC/ 4x5/8" (23)	21 - 23	150	76	90	20	260		
	61 1560 0478	UCC/ 4x7/8" (28)	27 - 28	150	76	90	20	340		
	61 1560 4118	UCC/ 4x1.1/8" (38)	36 - 38	200	108	114	20	340		
	61 1560 4114	UCC/ 4x1.1/4" (40)	39 - 40	200	108	114	20	400		
4 Cables 4 Câbles	61 1560 4158	UCC/ 4x1.5/8" (52)	50 - 52	250	132	137	20	400		
6 Cavi UCC/6	61 1560 0609	UCC/ 6x9	8 - 9	125	63	56	20	265		
	61 1560 0611	UCC/ 6x11	10 - 11	125	63	56	20	265		
	61 1560 0613	UCC/ 6x13	12 - 13	150	81	68	20	310		
	61 1560 0614	UCC/ 6x1/2" S (14)	13 - 14	150	81	68	20	310		
	61 1560 0638	UCC/ 6x3/8" (16)	15 - 16	150	81	68	20	310		
	61 1560 0612	UCC/ 6x1/2" (17)	16 - 17	150	81	68	20	310		
	61 1560 0658	UCC/ 6x5/8" (23)	21 - 23	200	114	90	20	415		
	61 1560 0678	UCC/ 6x7/8" (28)	27 - 28	200	114	90	20	415		
	61 1560 6114	UCC/ 6x1.1/4" (40)	39 - 40	250	150	114	20	490		
	6 Cables 6 Câbles	61 1560 6158	UCC/ 6x1.5/8" (52)	50 - 52	300	198	137	20	580	
8 Cavi UCC/8	61 1560 0809	UCC/ 8x9	8 - 9	150	84	56	20	300		
	61 1560 0811	UCC/ 8x11	10 - 11	150	84	56	20	300		
	61 1560 0813	UCC/ 8x13	12 - 13	200	108	68	20	255		
	61 1560 0814	UCC/ 8x1/2" S (14)	13 - 14	200	108	68	20	255		
	61 1560 0838	UCC/ 8x3/8" (16)	15 - 16	200	108	68	20	255		
	61 1560 0812	UCC/ 8x1/2" (17)	16 - 17	200	108	68	20	255		
	61 1560 0858	UCC/ 8x5/8" (23)	21 - 23	250	152	90	20	480		
	61 1560 0878	UCC/ 8x7/8" (28)	27 - 28	250	152	90	20	480		
	8 Cables 8 Câbles									

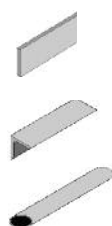

Esempio di fissaggio su angolare
Fixings example on angular



Befestigung-Beispiel an Winkel Eisen
Exemple de fixations sur cornière



UCP - Fissacavi doppi per profilato PCI 40x22

Composizione:
UCO + Inserto scorrevole ISL 8



UCP - Doppel Kabelschellen für C-Profilsschienen 40x22

Zusammenbau:
UCO + ISL 8 Schnellmontagemutter

UCP - Twin Cable Clamps for PCI 40x22 section

Composition:
UCO + ISL 8 sliding Insert



UCP - Fixations doubles pour profilé PCI 40x22

Composition:
UCO + Adaptateur rapide ISL 8

Figura Figure Abbildung Figure	Codice Code Artikel Nr. Code	Articolo Article Artikel Article	ø D	H	h1	L			g	Prezzo Price Preis Prix
<p>2 Cavi 2 Kabel</p> <p>UCP/2</p>	61 1561 0209	UCP/ 2x9	8 - 9	75	21	56			145	
	61 1561 0211	UCP/ 2x11	10 - 11	75	21	56			145	
	61 1561 0213	UCP/ 2x13	12 - 13	75	27	68			150	
	61 1561 0214	UCP/ 2x1/2" S (14)	13 - 14	75	27	68			150	
	61 1561 0238	UCP/ 2x3/8" (16)	15 - 16	75	27	68			150	
	61 1561 0212	UCP/ 2x1/2" (17)	16 - 17	75	27	68			150	
	61 1561 0258	UCP/ 2x5/8" (23)	21 - 23	100	38	90			205	
	61 1561 0278	UCP/ 2x7/8" (28)	27 - 28	100	38	90			205	
	61 1561 2118	UCP/ 2x1.1/8" (38)	36 - 38	150	54	114			250	
	61 1561 2114	UCP/ 2x1.1/4" (40)	39 - 40	150	54	114			250	
<p>2 Cables 2 Câbles</p>	61 1561 2158	UCP/ 2x1.5/8" (52)	50 - 52	150	66	137			330	
<p>4 Cavi 4 Kabel</p> <p>UCP/4</p>	61 1561 0409	UCP/ 4x9	8 - 9	100	42	56			170	
	61 1561 0411	UCP/ 4x11	10 - 11	100	42	56			170	
	61 1561 0413	UCP/ 4x13	12 - 13	125	54	56			190	
	61 1561 0414	UCP/ 4x1/2" S (14)	13 - 14	125	54	68			190	
	61 1561 0438	UCP/ 4x3/8" (16)	15 - 16	125	54	68			190	
	61 1561 0412	UCP/ 4x1/2" (17)	16 - 17	125	54	68			190	
	61 1561 0458	UCP/ 4x5/8" (23)	21 - 23	150	76	90			280	
	61 1561 0478	UCP/ 4x7/8" (28)	27 - 28	150	76	90			280	
	61 1561 4118	UCP/ 4x1.1/8" (38)	36 - 38	200	108	114			340	
	61 1561 4114	UCP/ 4x1.1/4" (40)	39 - 40	200	108	114			340	
<p>4 Cables 4 Câbles</p>	61 1561 4158	UCP/ 4x1.5/8" (52)	50 - 52	250	132	137			445	
<p>6 Cavi 6 Kabel</p> <p>UCP/6</p>	61 1561 0609	UCP/ 6x9	8 - 9	125	63	56			205	
	61 1561 0611	UCP/ 6x11	10 - 11	125	63	56			205	
	61 1561 0613	UCP/ 6x13	12 - 13	150	81	68			250	
	61 1561 0614	UCP/ 6x1/2" S (14)	13 - 14	150	81	68			250	
	61 1561 0638	UCP/ 6x3/8" (16)	15 - 16	150	81	68			250	
	61 1561 0612	UCP/ 6x1/2" (17)	16 - 17	150	81	68			250	
	61 1561 0658	UCP/ 6x5/8" (23)	21 - 23	200	114	90			350	
	61 1561 0678	UCP/ 6x7/8" (28)	27 - 28	200	114	90			350	
	61 1561 6114	UCP/ 6x1.1/4" (40)	39 - 40	250	150	114			430	
	<p>6 Cables 6 Câbles</p>	61 1561 6158	UCP/ 6x1.5/8" (52)	50 - 52	300	198	137			550
<p>8 Cavi 8 Kabel</p> <p>UCP/8</p>	61 1561 0809	UCP/ 8x9	8 - 9	150	84	56			240	
	61 1561 0811	UCP/ 8x11	10 - 11	150	84	56			240	
	61 1561 0813	UCP/ 8x13	12 - 13	200	108	68			195	
	61 1561 0814	UCP/ 8x1/2" S (14)	13 - 14	200	108	68			195	
	61 1561 0838	UCP/ 8x3/8" (16)	15 - 16	200	108	68			195	
	61 1561 0812	UCP/ 8x1/2" (17)	16 - 17	200	108	68			195	
	61 1561 0858	UCP/ 8x5/8" (23)	21 - 23	250	152	90			420	
	<p>8 Cables 8 Câbles</p>	61 1561 0878	UCP/ 8x7/8" (28)	27 - 28	250	152	90			420

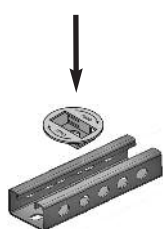

Esempio di fissaggio su profilati a "C"
Fixings example on "C"-profiles



Befestigung-Beispiel an "C"-Profil
Exemple de fixations sur profilé "C"

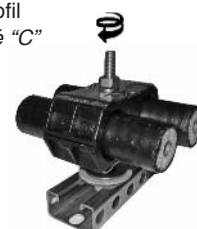
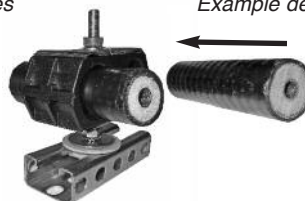

UCL - Fissacavi doppi per passerelle portacavi in filo

Composizione:
UCO + 2 piastre di spinta PUC 70



UCL - Doppel Kabelschellen für Gitterbahnen

Zusammenbau:
UCO + 2 PUC 70 Druckplatte

UCL - Twin Clamps for steel wire-mesh cable trays

Composition:
UCO + 2 PUC 70 steel pressure plates

UCL - Fixations doubles pour chemins de câble en treillis

Composition:
UCO + 2 plaques de compression PUC 70

Figura Figure Abbildung Figure	Codice Code Artikel Nr. Code	Articolo Article Artikel Article	ø D	H	h1	L			g	Prezzo Price Preis Prix
2 Cavi 2 Kabel UCL/2	61 1575 0209	UCL/ 2x9	8 - 9	75	21	56			168	
	61 1575 0211	UCL/ 2x11	10 - 11	75	21	56			168	
	61 1575 0213	UCL/ 2x13	12 - 13	75	27	68			170	
	61 1575 0214	UCL/ 2x1/2"S (14)	13 - 14	75	27	68			170	
	61 1575 0238	UCL/ 2x3/8" (16)	15 - 16	75	27	68			170	
	61 1575 0212	UCL/ 2x1/2" (17)	16 - 17	75	27	68			170	
	61 1575 0258	UCL/ 2x5/8" (23)	21 - 23	100	38	90			235	
	61 1575 0278	UCL/ 2x7/8" (28)	27 - 28	100	38	90			235	
	61 1575 2118	UCL/ 2x1.1/8" (38)	36 - 38	150	54	114			285	
	61 1575 2114	UCL/ 2x1.1/4" (40)	39 - 40	150	54	114			285	
2 Cables 2 Câbles	61 1575 2158	UCL/ 2x1.5/8" (52)	50 - 52	150	66	137			380	
4 Cavi 4 Kabel UCL/4	61 1575 0409	UCL/ 4x9	8 - 9	100	42	56			195	
	61 1575 0411	UCL/ 4x11	10 - 11	100	42	56			195	
	61 1575 0413	UCL/ 4x13	12 - 13	125	54	68			218	
	61 1575 0414	UCL/ 4x1/2"S (14)	13 - 14	125	54	68			218	
	61 1575 0438	UCL/ 4x3/8" (16)	15 - 16	125	54	68			218	
	61 1575 0412	UCL/ 4x1/2" (17)	16 - 17	125	54	68			218	
	61 1575 0458	UCL/ 4x5/8" (23)	21 - 23	150	76	90			320	
	61 1575 0478	UCL/ 4x7/8" (28)	27 - 28	150	76	90			390	
	61 1575 4118	UCL/ 4x1.1/8" (38)	36 - 38	200	108	114			390	
	61 1575 4114	UCL/ 4x1.1/4" (40)	39 - 40	200	108	114			512	
4 Cables 4 Câbles	61 1575 4158	UCL/ 4x1.5/8" (52)	50 - 52	250	132	137			235	
6 Cavi 6 Kabel UCL/6	61 1575 0609	UCL/ 6x9	8 - 9	125	63	56			235	
	61 1575 0611	UCL/ 6x11	10 - 11	125	63	56			235	
	61 1575 0613	UCL/ 6x13	12 - 13	150	81	68			285	
	61 1575 0614	UCL/ 6x1/2"S (14)	13 - 14	150	81	68			285	
	61 1575 0638	UCL/ 6x3/8" (16)	15 - 16	150	81	68			285	
	61 1575 0612	UCL/ 6x1/2" (17)	16 - 17	150	81	68			285	
	61 1575 0658	UCL/ 6x5/8" (23)	21 - 23	200	114	90			400	
	61 1575 0678	UCL/ 6x7/8" (28)	27 - 28	200	114	90			400	
	61 1575 6114	UCL/ 6x1.1/4" (40)	39 - 40	250	150	114			495	
	61 1575 6158	UCL/ 6x1.5/8" (52)	50 - 52	300	198	137			630	
8 Cavi 8 Kabel UCL/8	61 1575 0809	UCL/ 8x9	8 - 9	150	84	56			275	
	61 1575 0811	UCL/ 8x11	10 - 11	150	84	56			275	
	61 1575 0813	UCL/ 8x13	12 - 13	200	108	68			225	
	61 1575 0814	UCL/ 8x1/2"S (14)	13 - 14	200	108	68			225	
	61 1575 0838	UCL/ 8x3/8" (16)	15 - 16	200	108	68			225	
	61 1575 0812	UCL/ 8x1/2" (17)	16 - 17	200	108	68			225	
	61 1575 0858	UCL/ 8x5/8" (23)	21 - 23	250	152	90			480	
	61 1575 0878	UCL/ 8x7/8" (28)	27 - 28	250	152	90			480	

Esempio di fissaggio su passerelle portacavi in filo d'acciaio
Fixings example on steel wire-mesh cable trays



Befestigung-Beispiel für Gitterbahnen
Exemple de fixations sur chemins de câble en treillis

