

USO-USC-USP-USL

Fissacavi singoli per cavi coassiali

Versioni:

- ① **USO** per piatto forato
- ② **USC** per piatto, tondo e angolare
- ③ **USP** per profilato **PCI 40x22**
- ④ **USL** per passerelle portacavi in filo d'acciaio

Composizione:

- 1 - Monosella calibrata **SAM** di H.D.P.E. rinforzato vetro
- 2 - Barra filettata - **BFI M8** (M10 a richiesta)
- 3 - Rondelle piane **RPI 10/20**
- 4 - Dadi esagonali **DAI 8**
- 5 - Cerniera flessibile
- 6 - Rondella Elastica **REI 8**

Impiego:

Fissaggio 1 - 4 cavi coassiali.
Fissaggio di guide d'onda mediante guarnizioni elastiche **GRE-GRQ-GRR**.

Materiale:

Acciaio INOX AISI 304.
H.D.P.E. rinforzato con fibra di vetro, resistente a U.V.
Colore: nero (grigio a richiesta).

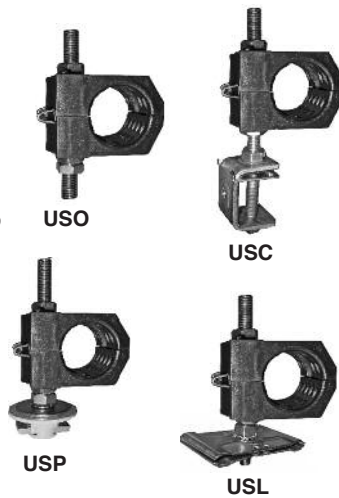

USO-USC-USP-USL

Einzel-Schellen für Koaxialkabel

Versionen:

- ① **USO** für gelochtes Flacheisen
- ② **USC** für Flach-, Rund-, Winkelisen
- ③ **USP** für Profil **PCI 40x22**
- ④ **USL** für Gitterbahnen

Zusammenbau:

- 1 - **SAM** Einzel-Wanne aus glasf. verst. H.D.P.E.
- 2 - Gewindestange - **BFI M8** (M10 auf Anfrage)
- 3 - Unterlegscheiben **RPI 10/20**
- 4 - **DAI 8** Muttern
- 5 - Flexibles Scharniergelenk
- 6 - **REI 8** Sicherungsscheiben

Einsatz:

Befestigung von 1 - 4 Koaxialkabeln.
Mittels elastischen Klemmprofilen **GRE-GRQ-GRR** auch von Wellenleitern.

Material:

Stahl AISI 304 (V2A).
H.D.P.E. glasfaserverstärkt, U.V. - beständig.
Farbe: schwarz (grau auf Anfrage).

USO-USC-USP-USL

Single Clamps for Coaxial Cables

Versions:

- ① **USO** for flat iron with holes
- ② **USC** for flat, round, angular
- ③ **USP** for **PCI 40x22** profile
- ④ **USL** for steel wire cable trays

Components:

- 1 - **SAM** single Saddle of glass reinf. H.D.P.E.
- 2 - Threaded Bar - **BFI M8** (M10 on request)
- 3 - **RPI 10/20** flat Washers
- 4 - **DAI 8** Hexagon nuts
- 5 - Flexible Hinge
- 6 - **REI 8** Elastic Washer

Use:

Fixing 1 to 4 coaxial cables.
GRE-GRQ-GRR elastic cushions allow fastening of waveguides.

Material:

AISI 304 Stainless steel.
Fiberglass reinforced H.D.P.E., U.V. proof.
Colour: black (grey on request).

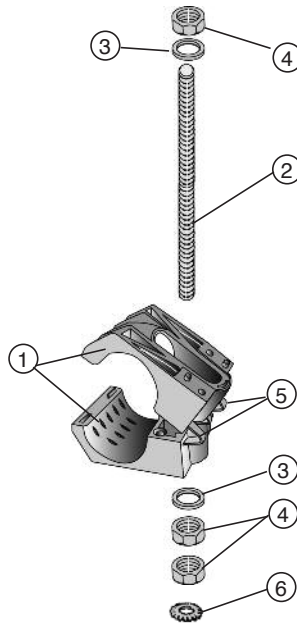

USO-USC-USP-USL

Fixations simples pour câbles coaxiaux

Versions:

- ① **USO** pour fer plat avec trous
- ② **USC** pour plat, rond et cornière
- ③ **USP** pour profilé **PCI 40x22**
- ④ **USL** pour structures en fil acier

Composants:

- 1 - Garniture simple **SAM** en H.D.P.E. chargé verre
- 2 - Tige filetée - **BFI M8** (M10 sur demande)
- 3 - Rondelles plates **RPI 10/20**
- 4 - Ecrous hexagonaux **DAI 8**
- 5 - Charnière flexible
- 6 - Rondelle dentelées **REI 8**

Emploi:

Fixation de 1 à 4 câbles coaxiaux.
Fixation de guides d'onde par garnitures **GRE-GRQ-GRR**.

Matériel:

Inox AISI 304.
H.D.P.E. chargé verre, résistant aux U.V.
Couleur: noir (gris sur demande).

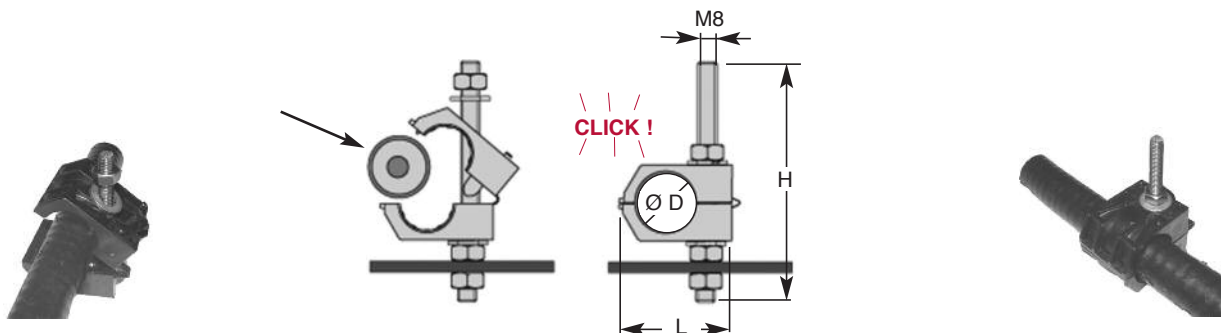

SAM - Monoselle incernierate (brev.)

Grazie alla dentellatura speciale interna fanno presa sul cavo coassiale senza comprimerlo né deformarlo. La chiusura della sella è calibrata sui diametri dei cavi coassiali.
Una cerniera flessibile (brev.) consente l'apertura e la chiusura controllata dei due gusci

Materiale:

H.D.P.E. rinforzato con fibra di vetro.
Resistente ai raggi U.V. (-50°C ÷ +80°C)
Colore: nero (grigio a richiesta).



Cerniera flessibile (brev.)
Flexible hinge (Pat.)
Flexibles Scharniergelenk (Pat.)
Charnière flexible (Brev.)

SAM - Hinged Single Saddles (Pat.)

The internal indentation allows gripping on the cable without compressing nor deforming it.
The saddle size is calibrated and corresponds to the diameter of the coaxial cables.
A flexible hinge (patented) allows a controlled opening and closing of the two shells

Material:

Fiberglass reinforced H.D.P.E.
U.V. proof. (-50°C ÷ +80°C)
Colour: black (grey on request).

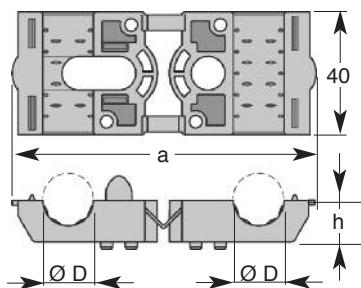

SAM - Scharnier Einzel-Wannen (Pat.)

Die Wannen entsprechen dem Standarddurchmesser der RF-Koaxialkabeln die formschlüssig eingebettet werden. Innenangebrachte Noppen haften am Kabelmantel ohne ihn zusammenzudrücken oder zu beschädigen. Ein flexibles Scharniergelenk (Pat.) erleichtert das Zusammenklappen der zwei Halbwannen

Material:

H.D.P.E. glasfaserverstärkt.
U.V. beständig (-50°C ÷ +80°C)
Farbe: schwarz (grau auf Anfrage).

SAM - Garnitures pivotantes sur charnière (brev.)

Elles sont calibrées pour le diamètre des câbles coaxiaux. Grâce aux dentelures intérieures elles fixent le câble sans le comprimer ni le déformer.
Une charnière flexible (brev.) permet le contrôle de l'ouverture et de la fermeture des deux parties

Matériel:

H.D.P.E. renforcé fibre de verre.
Résistant aux rayons U.V. (-50°C ÷ +80°C)
Couleur: noir (gris sur demande).



Figura Figure Abbildung Figure	Codice Code Artikel Nr. Code	Articolo Article Artikel Article	a	L	Ø D	h	h1				Prezzo Price Preis Code
	61 3315 0011	SAM/ 1x11	92	44	10-11	10,5	21	20	500	16	
	61 3315 0014	SAM/ 1x1/2" S (14)	103	50	13-14	13,5	27	20	500	24	
	61 3315 0012	SAM/ 1x1/2" (17)	103	50	16-17	13,5	27	20	500	22	
	61 3315 0078	SAM/ 1x7/8 (28)	122	59	27-28	19	38	20	100	32	
	61 3315 0114	SAM/ 1x1.1/4" (40)	145	70	39-40	27	54	20	100	50	
	61 3315 0158	SAM/ 1x1.5/8" (52)	165	80	50-52	33	66	20	100	60	



USO - Fissacavi per piatto forato

Composizione:
Sella **SAM** + perno filettato M8 + dadi + rondelle

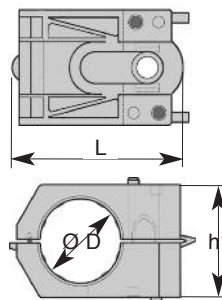

USO - Kabelschellen für gelochtes Flacheisen

Zusammenbau:
SAM Wanne + Gewindest. M8 + Muttern + Scheiben

USO - Cable Clamps for flat iron with holes

Composition:
SAM Saddle + M8 threaded bar + nuts + washers

USO - Fixations pour fer plat avec trous

Composition:
Garniture **SAM** + tige fil. M8 + écrous + rondelles

Figura Figure Abbildung Figure	Codice Code Artikel Nr. Code	Articolo Article Artikel Article	ø D	H	h1	L			g 	Prezzo Price Preis Prix
<p>1 Cavo 1 Kabel</p> <p>USO/1</p>	61 1571 0011	USO/ 1x11	10-11	75	21	44			47	
	61 1571 0014	USO/ 1x1/2" S (14)	13-14	75	27	50			50	
	61 1571 0012	USO/ 1x1/2" (17)	16-17	75	27	50			50	
	61 1571 0078	USO/ 1x7/8" (28)	27-28	100	38	59			77	
	61 1571 0114	USO/ 1x1.1/4" (40)	39-40	100	54	70			100	
	61 1571 0158	USO/ 1x1.5/8" (52)	50-52	125	66	80			140	
<p>2 Cavi 2 Kabel</p> <p>USO/2</p>	61 1571 0211	USO/ 2x11	10-11	100	42	44			60	
	61 1571 0214	USO/ 2x1/2" S (14)	13-14	100	54	50			75	
	61 1571 0212	USO/ 2x1/2" (17)	16-17	100	54	50			75	
	61 1571 0278	USO/ 2x7/8" (28)	27-28	125	76	59			115	
	61 1571 2114	USO/ 2x1.1/4" (40)	39-40	200	108	70			145	
	61 1571 2158	USO/ 2x1.5/8" (52)	50-52	200	132	80			197	
<p>3 Cavi 3 Kabel</p> <p>USO/3</p>	61 1571 0311	USO/ 3x11	10-11	100	63	44			77	
	61 1571 0314	USO/ 3x1/2" S (14)	13-14	125	81	50			100	
	61 1571 0312	USO/ 3x1/2" (17)	16-17	125	81	50			100	
	61 1571 0378	USO/ 3x7/8" (28)	27-28	200	114	59			152	
	61 1571 3114	USO/ 3x1.1/4" (40)	39-40	250	150	70			190	
	61 1571 3158	USO/ 3x1.5/8" (52)	50-52	300	198	80			260	
<p>4 Cavi 4 Kabel</p> <p>USO/4</p>	61 1571 0411	USO/ 4x11	10-11	125	84	44			95	
	61 1571 0414	USO/ 4x1/2" S (14)	13-14	150	108	50			172	
	61 1571 0412	USO/ 4x1/2" (17)	16-17	150	108	50			172	
	61 1571 0478	USO/ 4x7/8" (28)	27-28	200	152	59			185	
	61 1571 4114	USO/ 4x1.1/4" (40)	39-40	300	216	70			235	
	61 1571 4158	USO/ 4x1.5/8" (52)	50-52	400	264	80			323	

Esempio di fissaggio piatti forati
Fixings example on flat iron with holes

Befestigung-Beispiel an gelochtes Flacheisen
Exemple de fixations sur fer plat avec trous

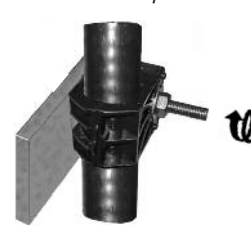
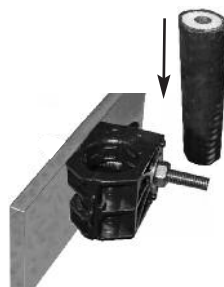
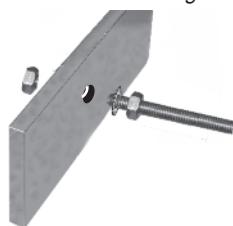

SOLUZIONI
PER L'INSTALLAZIONE

SOLUTIONS
FOR INSTALLATIONS



LÖSUNGEN
FÜR INSTALLATIONEN

SOLUTIONS
POUR L'INSTALLATION

USC - Fissacavi per piatti, tondi e angolari

Composizione:
USO + mini morsetto MIM 8



USC - Kabelschellen für Flach, Rund, Winkeleisen

Zusammenbau:
USO + Miniklemme MIM 8

USC - Cable Clamps for flat, round and angular

Composition:
USO + MIM 8 Mini Clamp

USC - Fixations pour plat, rond et cornière

Composition:
USO + mini fixation MIM 8

Figura Figure Abbildung Figure	Codice Code Artikel Nr. Code	Articolo Article Artikel Article	ø D	H	h1	L			g 	Prezzo Price Preis Prix
<p>1 Cavo 1 Kabel</p> <p>USC/1</p>	61 1572 0011	USC/ 1x11	10-11	75	21	44			102	
	61 1572 0014	USC/ 1x1/2" S (14)	13-14	75	27	50			105	
	61 1572 0012	USC/ 1x1/2" (17)	16-17	75	27	50			105	
	61 1572 0078	USC/ 1x7/8" (28)	27-28	100	38	59			132	
	61 1572 0114	USC/ 1x1.1/4" (40)	39-40	100	54	70			155	
	61 1572 0158	USC/ 1x1.5/8" (52)	50-52	125	66	80			155	
<p>2 Cavi 2 Kabel</p> <p>USC/2</p>	61 1572 0211	USC/ 2x11	10-11	100	42	44			115	
	61 1572 0214	USC/ 2x1/2" S (14)	13-14	100	54	50			130	
	61 1572 0212	USC/ 2x1/2" (17)	16-17	100	54	50			130	
	61 1572 0278	USC/ 2x7/8" (28)	27-28	125	76	59			170	
	61 1572 2114	USC/ 2x1.1/4" (40)	39-40	200	108	70			200	
	61 1572 2158	USC/ 2x1.5/8" (52)	50-52	200	132	80			200	
<p>3 Cavi 3 Kabel</p> <p>USC/3</p>	61 1572 0311	USC/ 3x11	10-11	100	63	44			132	
	61 1572 0314	USC/ 3x1/2" S (14)	13-14	125	81	50			155	
	61 1572 0312	USC/ 3x1/2" (17)	16-17	125	81	50			155	
	61 1572 0378	USC/ 3x7/8" (28)	27-28	200	114	59			207	
	61 1572 3114	USC/ 3x1.1/4" (40)	39-40	250	150	70			245	
	61 1572 3158	USC/ 3x1.5/8" (52)	50-52	300	198	80			290	
<p>4 Cavi 4 Kabel</p> <p>USC/4</p>	61 1572 0411	USC/ 4x11	10-11	125	84	44			150	
	61 1572 0414	USC/ 4x1/2" S (14)	13-14	150	108	50			167	
	61 1572 0412	USC/ 4x1/2" (17)	16-17	150	108	50			167	
	61 1572 0478	USC/ 4x7/8" (28)	27-28	200	152	59			240	
	61 1572 4114	USC/ 4x1.1/4" (40)	39-40	300	216	70			280	
	61 1572 4158	USC/ 4x1.5/8" (52)	50-52	400	264	80			325	

Esempio di fissaggio su angolare
Fixings example on angular

Befestigung-Beispiel an Winkel Eisen
Example de fixations sur cornière

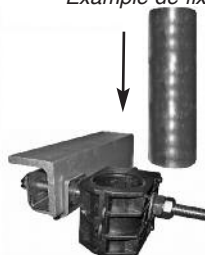
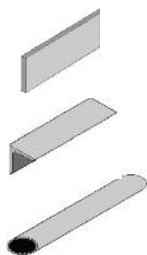

SOLUZIONI
PER L'INSTALLAZIONE

SOLUTIONS
FOR INSTALLATIONS



LOSUNGEN
FÜR INSTALLATIONEN

SOLUTIONS
POUR L'INSTALLATION

USP - Fissacavi per profilato PCI 40x22

Composizione:
USO + inserto scorrevole ISL 8

USP - Cable Clamps for PCI 40x22 section

Composition:
USO + ISL 8 sliding Insert



USP - Kabelschellen für C-Profilschienen 40x22

Zusammenbau:
USO + ISL 8 Schnellmontagemutter

USP - Fixations pour profilé PCI 40x22

Composition:
USO + adaptateur rapide ISL 8

Figura Figure Abbildung Figure	Codice Code Artikel Nr. Code	Articolo Article Artikel Article	ø D	H	h1	L		g	Prezzo Price Preis Prix
<p>1 Cavo 1 Kabel</p> <p>USP/1</p>	61 1573 0011	USP/ 1x11	10-11	75	21	44		72	
	61 1573 0014	USP/ 1x1/2" S (14)	13-14	75	27	50		75	
	61 1573 0012	USP/ 1x1/2" (17)	16-17	75	27	50		75	
	61 1573 0078	USP/ 1x7/8" (28)	27-28	100	38	59		102	
	61 1573 0114	USP/ 1x1.1/4" (40)	39-40	100	54	70		125	
	61 1573 0158	USP/ 1x1.5/8" (52)	50-52	125	66	80		165	
<p>2 Cavi 2 Kabel</p> <p>USP/2</p>	61 1573 0211	USP/ 2x11	10-11	100	42	44		85	
	61 1573 0214	USP/ 2x1/2" S (14)	13-14	100	54	50		95	
	61 1573 0212	USP/ 2x1/2" (17)	16-17	100	54	50		95	
	61 1573 0278	USP/ 2x7/8" (28)	27-28	125	76	59		140	
	61 1573 2114	USP/ 2x1.1/4" (40)	39-40	200	108	70		170	
	61 1573 2158	USP/ 2x1.5/8" (52)	50-52	200	132	80		222	
<p>3 Cavi 3 Kabel</p> <p>USP/3</p>	61 1573 0311	USP/ 3x11	10-11	100	63	44		102	
	61 1573 0314	USP/ 3x1/2" S (14)	13-14	125	81	50		125	
	61 1573 0312	USP/ 3x1/2" (17)	16-17	125	81	50		125	
	61 1573 0378	USP/ 3x7/8" (28)	27-28	200	114	59		175	
	61 1573 3114	USP/ 3x1.1/4" (40)	39-40	250	150	70		215	
	61 1573 3158	USP/ 3x1.5/8" (52)	50-52	300	198	80		275	
<p>4 Cavi 4 Kabel</p> <p>USP/4</p>	61 1573 0411	USP/ 4x11	10-11	125	84	44		120	
	61 1573 0414	USP/ 4x1/2" S (14)	13-14	150	108	50		197	
	61 1573 0412	USP/ 4x1/2" (17)	16-17	150	108	50		197	
	61 1573 0478	USP/ 4x7/8" (28)	27-28	200	152	59		210	
	61 1573 4114	USP/ 4x1.1/4" (40)	39-40	300	216	70		250	
	61 1573 4158	USP/ 4x1.5/8" (52)	50-52	400	264	80		310	

Esempio di fissaggio su profilati a "C"
Fixings example on "C"-profiles

Befestigung-Beispiel an "C"-Profil
Example de fixations sur profilé "C"

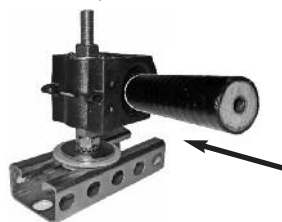
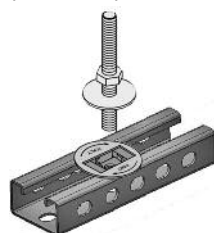
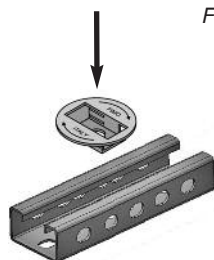

SOLUZIONI
PER L'INSTALLAZIONE

SOLUTIONS
FOR INSTALLATIONS



LÖSUNGEN
FÜR INSTALLATIONEN

SOLUTIONS
POUR L'INSTALLATION

USL - Fissacavi per passerelle portacavi in filo

Composizione:
USO + 2 piastre di spinta PUC 70



USL - Kabelschellen für Gitterbahnen

Zusammenbau:
USO + 2 PUC 70 Druckplatte

USL - Cable Clamps for steel wire-mesh cable trays

Composition:
USO + 2 PUC 70 steel pressure plates

USL - Fixations pour chemins de câble en treillis

Composition:
USO + 2 plaques de compression PUC 70

Figura Figure Abbildung Figure	Codice Code Artikel Nr. Code	Articolo Article Artikel Article	ø D	H	h1	L			g 	Prezzo Price Preis Prix
1 Cavo 1 Kabel USL/1	61 1578 0011	USL/ 1x11	10-11	75	21	44	20		83	
	61 1578 0014	USL/ 1x1/2"S (14)	13-14	75	27	50	20		85	
	61 1578 0012	USL/ 1x1/2" (17)	16-17	75	27	50	20		85	
	61 1578 0078	USL/ 1x7/8" (28)	27-28	100	38	59	20		115	
	61 1578 0114	USL/ 1x1.1/4" (40)	39-40	100	54	70	20		144	
	61 1578 0158	USL/ 1x1.5/8" (52)	50-52	125	66	80	20		190	
2 Cavi 2 Kabel USL/2	61 1578 0211	USL/ 2x11	10-11	100	42	44	20		98	
	61 1578 0214	USL/ 2x1/2"S (14)	13-14	100	54	50	20		110	
	61 1578 0212	USL/ 2x1/2" (17)	16-17	100	54	50	20		110	
	61 1578 0278	USL/ 2x7/8" (28)	27-28	125	76	59	20		160	
	61 1578 2114	USL/ 2x1.1/4" (40)	39-40	200	108	70	20		195	
	61 1578 2158	USL/ 2x1.5/8" (52)	50-52	200	132	80	20		255	
3 Cavi 3 Kabel USL/3	61 1578 0311	USL/ 3x11	10-11	100	63	44	20		117	
	61 1578 0314	USL/ 3x1/2"S (14)	13-14	125	81	50	20		144	
	61 1578 0312	USL/ 3x1/2" (17)	16-17	125	81	50	20		144	
	61 1578 0378	USL/ 3x7/8" (28)	27-28	200	114	59	20		200	
	61 1578 3114	USL/ 3x1.1/4" (40)	39-40	250	150	70	20		248	
	61 1578 3158	USL/ 3x1.5/8" (52)	50-52	300	198	80	20		315	
4 Cavi 4 Kabel USL/4	61 1578 0411	USL/ 4x11	10-11	125	84	44	20		140	
	61 1578 0414	USL/ 4x1/2"S (14)	13-14	150	108	50	20		212	
	61 1578 0412	USL/ 4x1/2" (17)	16-17	150	108	50	20		212	
	61 1578 0478	USL/ 4x7/8" (28)	27-28	200	152	59	20		240	
	61 1578 4114	USL/ 4x1.1/4" (40)	39-40	300	216	70	20		285	
	61 1578 4158	USL/ 4x1.5/8" (52)	50-52	400	264	80	20		356	

Esempio di fissaggio su passerelle fissacavi in filo d'acciaio
Fixings example on steel wire-mesh cable trays

Befestigung-Beispiel für Gitterbahnen
Exemple de fixations sur chemins de câble en treillis

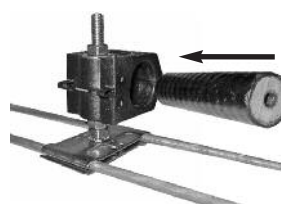

SOLUZIONI
PER L'INSTALLAZIONE

SOLUTIONS
FOR INSTALLATIONS



LÖSUNGEN
FÜR INSTALLATIONEN

SOLUTIONS
POUR L'INSTALLATION